

1. EXISTING SITE PLAN

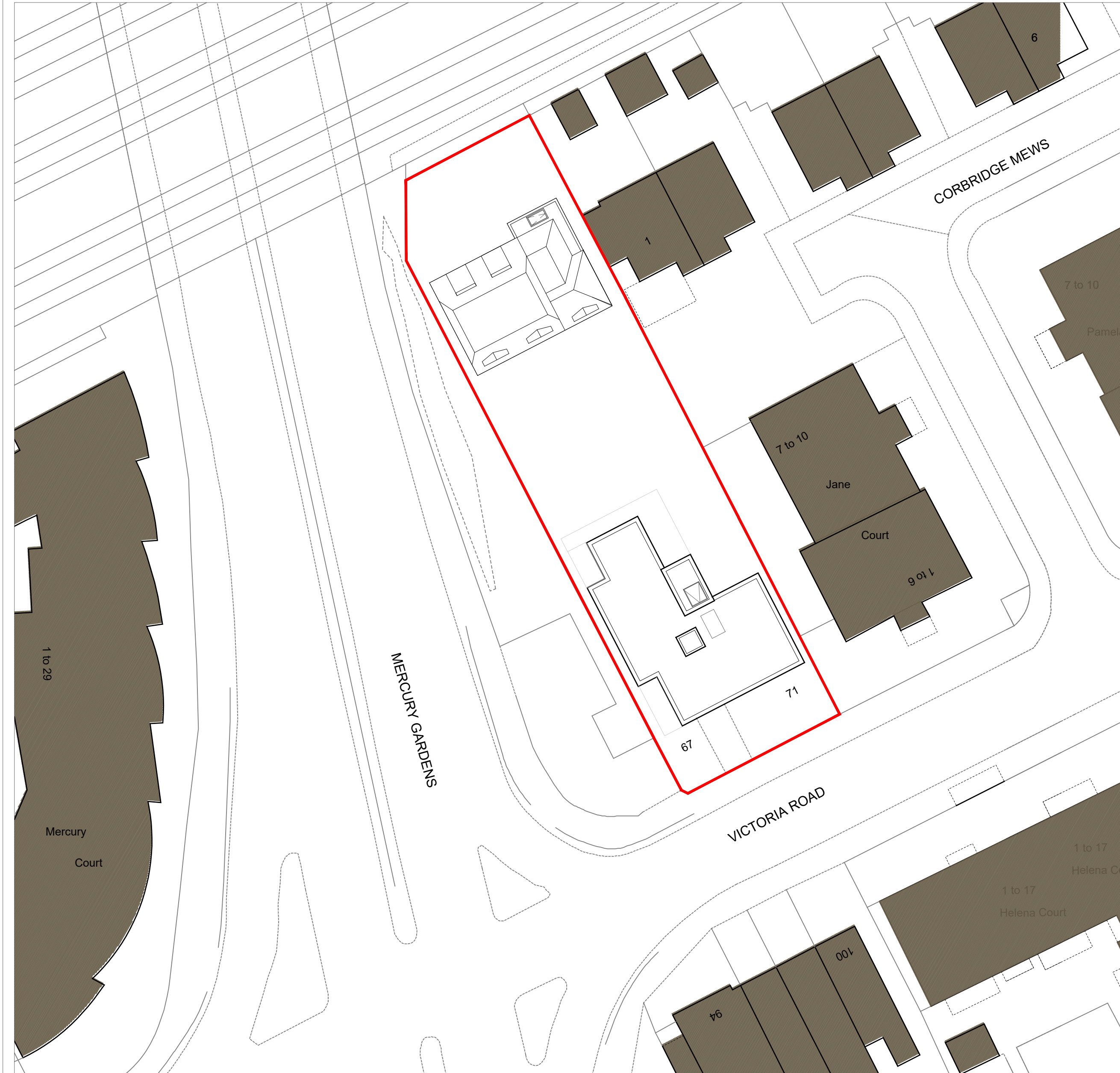

2. PROPOSED SITE PLAN

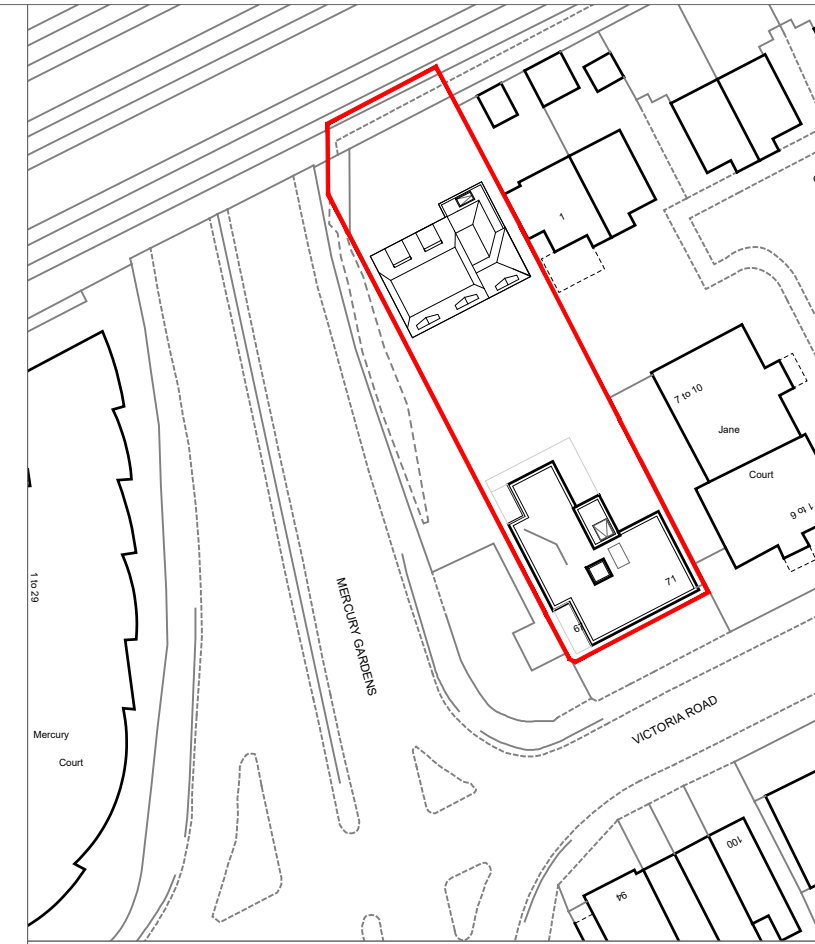

Key Plan

GENERAL NOTES

1. These proposals are subject to the approval of all Statutory Building Control requirements and the requirements of all Statutory Authorities and Service Providers.
2. The site boundaries and surroundings are based on the following:
OS Map
The site boundaries are those described by the client.
3. These drawings are to be read in conjunction with all other relevant documentation produced by DCSK and other consultants employed by the client.

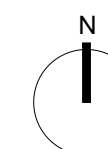

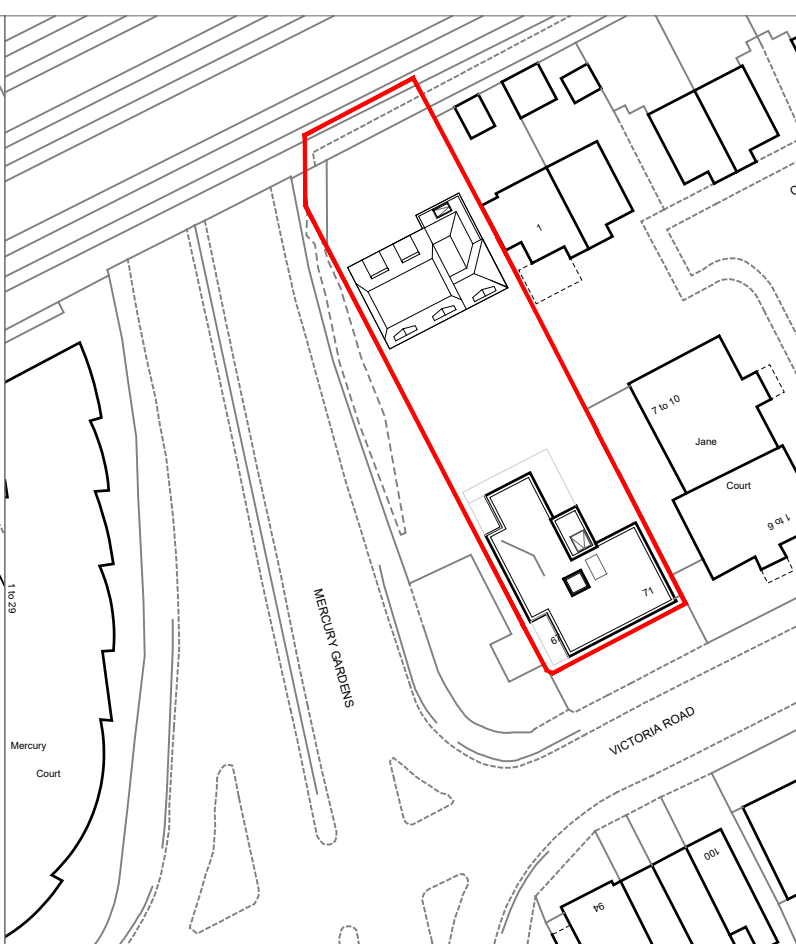

Key Plan

GENERAL NOTES

1. These proposals are subject to the approval of all Statutory Building Control requirements and the requirements of all Statutory Authorities and Service Providers.
2. The site boundaries and surroundings are based on the following:
OS Map
The site boundaries are those described by the client.
3. These drawings are to be read in conjunction with all other relevant documentation produced by DCSK and other consultants employed by the client.

A. Pilkington Optifloat Tint body-tinted glass at upper portion of window over 1850 from external ground level and Pilkington Optifloat Satin obscured glass at lower portion.

B. Soft mature landscaped verge at Apartment 4 window location

NOTE: See A-104 for apartment areas and internal dimensions and A-105 for House plans

DCSK
91 Swains Lane, London N6 6PJ
+44 7730 762745 paul@DCSK.design

Client **Victoria Road Romford, Ltd.**
Project 67-71 Victoria Rd, Romford, RM1 2LT
Havering Local Authority, project 0185

Scale 1: 100
Site Boundary

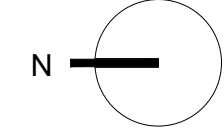

P 01 Issued to Consultants 2024/ 04/ 29
P 02 Cutback at rear of House 1 Roof Form 2024/ 05/ 22
P 03 House 1 at Two Storeys: Issued to Consultants 2024/ 06/ 11

2024/ 06/ 11

A 100

GROUND FLOOR PLAN

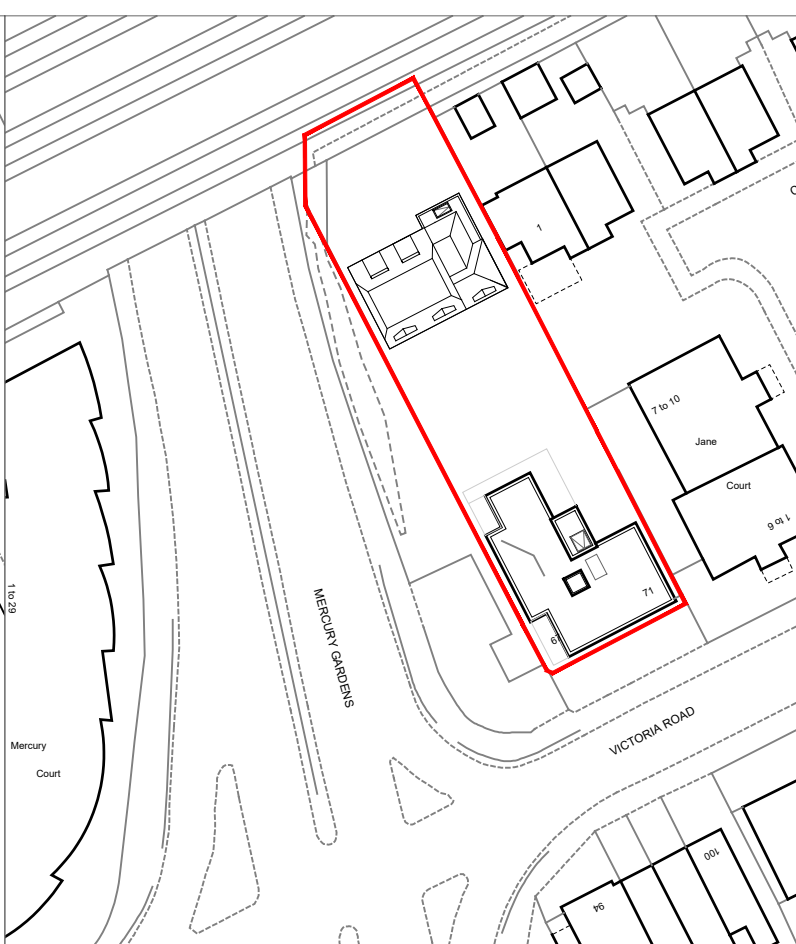

Key Plan

GENERAL NOTES

1. These proposals are subject to the approval of all Statutory Building Control requirements and the requirements of all Statutory Authorities and Service Providers.
2. The site boundaries and surroundings are based on the following:
OS Map
The site boundaries are those described by the client.
3. These drawings are to be read in conjunction with all other relevant documentation produced by DCSK and other consultants employed by the client.

C. Opaque glass at flank window and for stairwell window.

NOTE: See A-104 for apartment areas and internal dimensions and A-105 for House plans

DCSK
91 Swains Lane, London N6 6PJ
+44 7730 762745 paul@DCSK.design

Client **Victoria Road Romford, Ltd.**
Project 67-71 Victoria Rd, Romford, RM1 2LT
Havering Local Authority, project 0185

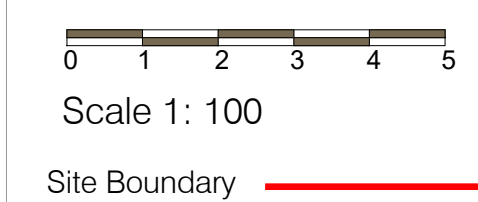

P 01 Issued to Consultants 2024/ 04/ 29
P 02 Cutback at rear of House 1 Roof Form 2024/ 05/ 22
P 03 House 1 at Two Storeys: Issued to Consultants 2024/ 06/ 11

2024/ 06/ 11

A 101

FIRST FLOOR PLAN

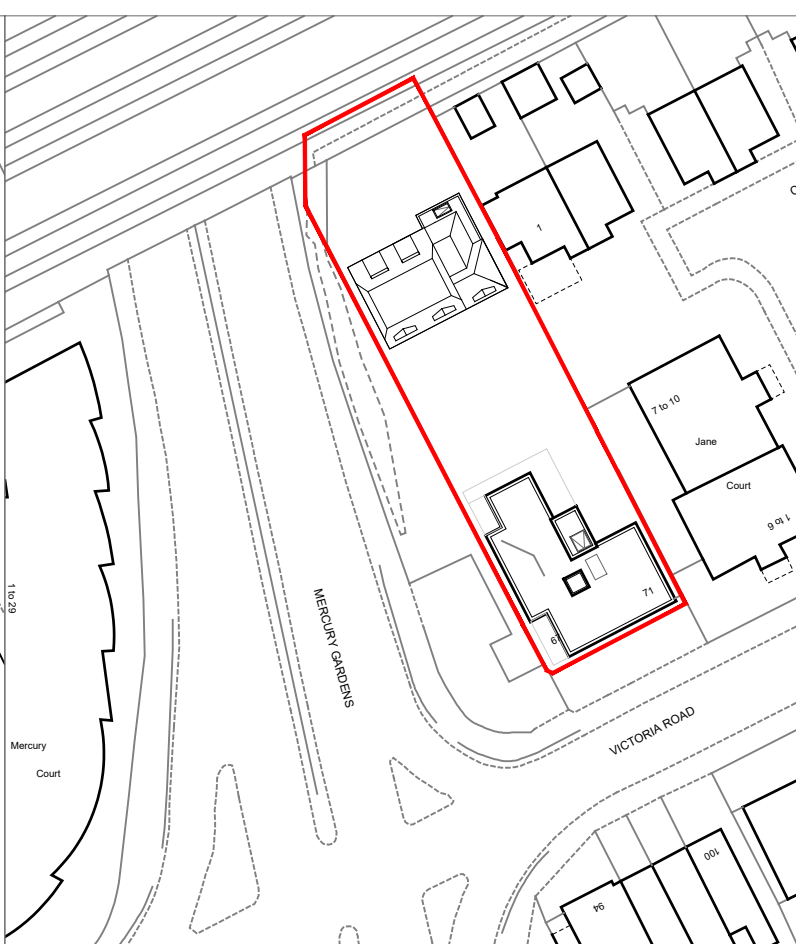

Key Plan

GENERAL NOTES

1. These proposals are subject to the approval of all Statutory Building Control requirements and the requirements of all Statutory Authorities and Service Providers.
2. The site boundaries and surroundings are based on the following:
OS Map
The site boundaries are those described by the client.
3. These drawings are to be read in conjunction with all other relevant documentation produced by DCSK and other consultants employed by the client.

C. Opaque glass at flank window and for stairwell window.

NOTE: See A-104 for apartment areas and internal dimensions and A-105 for House plans

DCSK
91 Swains Lane, London N6 6PJ
+44 7730 762745 paul@DCSK.design

Client **Victoria Road Romford, Ltd.**
Project **67-71 Victoria Rd, Romford, RM1 2LT**
Havering Local Authority, project 0185

Scale 1: 100
Site Boundary

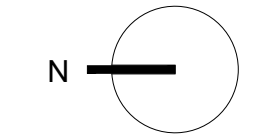

P 01 Issued to Consultants 2024/ 04/ 29
P 02 Cutback at rear of House 1 Roof Form 2024/ 05/ 22
P 03 House 1 at Two Storeys: Issued to Consultants 2024/ 06/ 11

2024/ 06/ 11

A 102

SECOND FLOOR PLAN

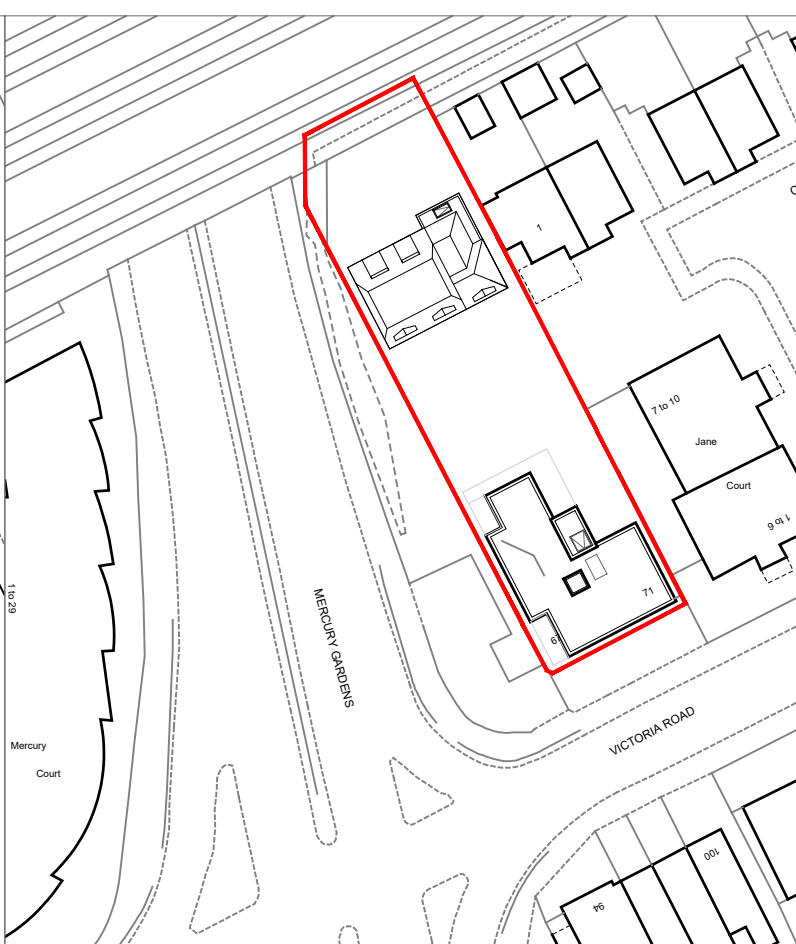

Key Plan

GENERAL NOTES

1. These proposals are subject to the approval of all Statutory Building Control requirements and the requirements of all Statutory Authorities and Service Providers.
2. The site boundaries and surroundings are based on the following:
OS Map
The site boundaries are those described by the client.
3. These drawings are to be read in conjunction with all other relevant documentation produced by DCSK and other consultants employed by the client.

DCSK
91 Swains Lane, London N6 6PJ
+44 7730 762745 paul@DCSK.design

Client **Victoria Road Romford, Ltd.**
Project **67-71 Victoria Rd, Romford, RM1 2LT**
Havering Local Authority, project 0185

Scale 1: 100

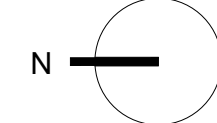

Site Boundary

P 01 Issued to Consultants 2024/ 04/ 29
P 02 Cutback at rear of House 1 Roof Form 2024/ 05/ 22
P 03 House 1 at Two Storeys: Issued to Consultants 2024/ 06/ 11

2024/ 06/ 11

A 103

ROOF PLAN