

Shop - Colchester, CO1

TO LET

40 Long Wyre Street,
Colchester, Essex, CO1 1LJ

Harston&Co

For more information call us
on 020 3371 0061



Highlights

- Vacant ground floor unit located in the heart of Colchester town centre
- Approximately 1,207 square feet (112.2 square metres)
- Available with a new lease and no premium
- EPC Rating – D

Location

The property is located on Long Wyre Street, in the heart of Colchester Town shopping district. Colchester is the largest settlement in Essex and is famed for being the first major city in Roman Britain. It is 50 miles (80 kilometers) northeast of London and is connected to London by the A12 and the Great Eastern Main Line railway. London Liverpool Street station can be reached in just over an hour from either Colchester Town station which is 0.4 miles away or Colchester station which is 1 mile away. The area is well served by buses.

Please note all times and distances given are approximate only.

Description

A ground-floor commercial unit arranged over ground floor only. The property measures 1,207 square feet (112.2 square metres) and benefits from glazed frontage, shutters, and suspended ceiling.

Please note that the sizes given are approximate only and sizes have been obtained from the VOA. All interested parties are advised to rely on their own inspection and survey.

Business Rates

2024 Ratable Value: £24,250

UBR (2024/25): 49.9p/£

Rates Payable: £12,100.75

These figures have been provided by the VOA. All interested parties are advised to make their own enquiries to confirm the accuracy of these figures with the Colchester City Council business rates department.

Terms

The property is available with a new lease at £25,000 per annum with further terms to be agreed. All negotiations are strictly subject to contract.

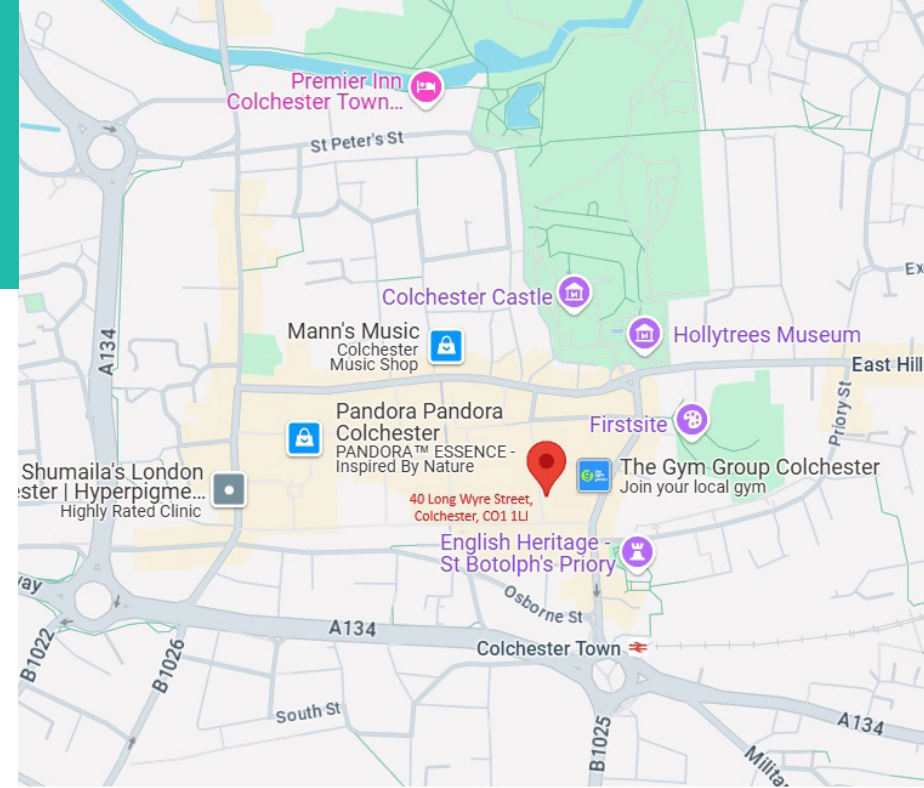

Rent:

£25,000 per annum

Harston&Co

[harstonandco.co.uk](https://www.harstonandco.co.uk)

020 3371 0061

info@harstonandco.co.uk

[in](#) [t](#) [@](#) @harstonandco

Subject to contract Harston&Co on its behalf and for the vendors or lessors of this property whose agents give notice that: The particulars within this document are for general guidance only and do not constitute any part of an offer or contract for sale or lease. Any statements or representations should not be relied upon as fact, and any interested parties should satisfy themselves as to the accuracy of any statement. Unless otherwise stated, all prices and rents are exclusive of VAT and are subject to change. Harston&Co is the trading name of Harston Property Ltd registered in England No: 10618714.

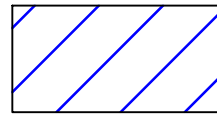

AREA HATCHED IN BLUE ARE SHARED AREAS, USED IN COMMON WITH OTHER OCCUPIERS OF THE BUILDING

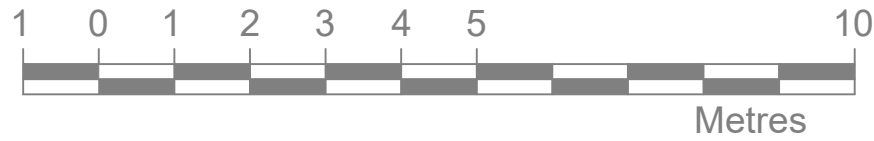

GROUND FLOOR PLAN

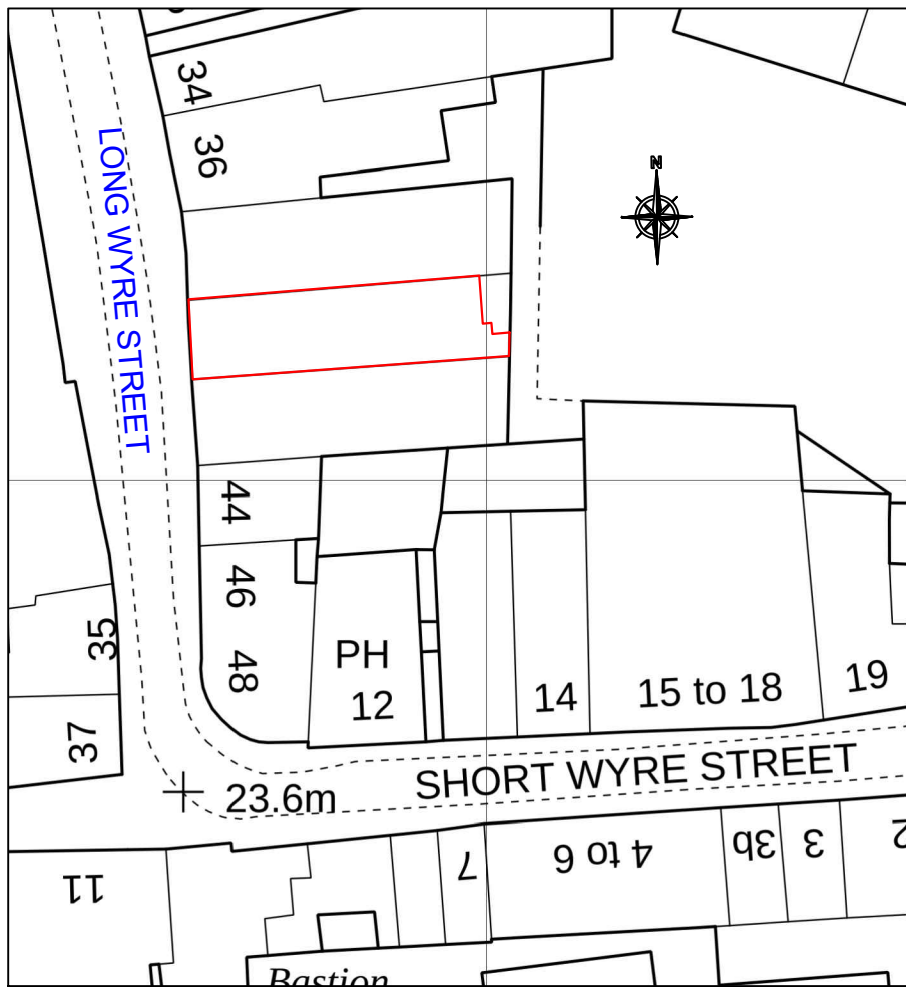
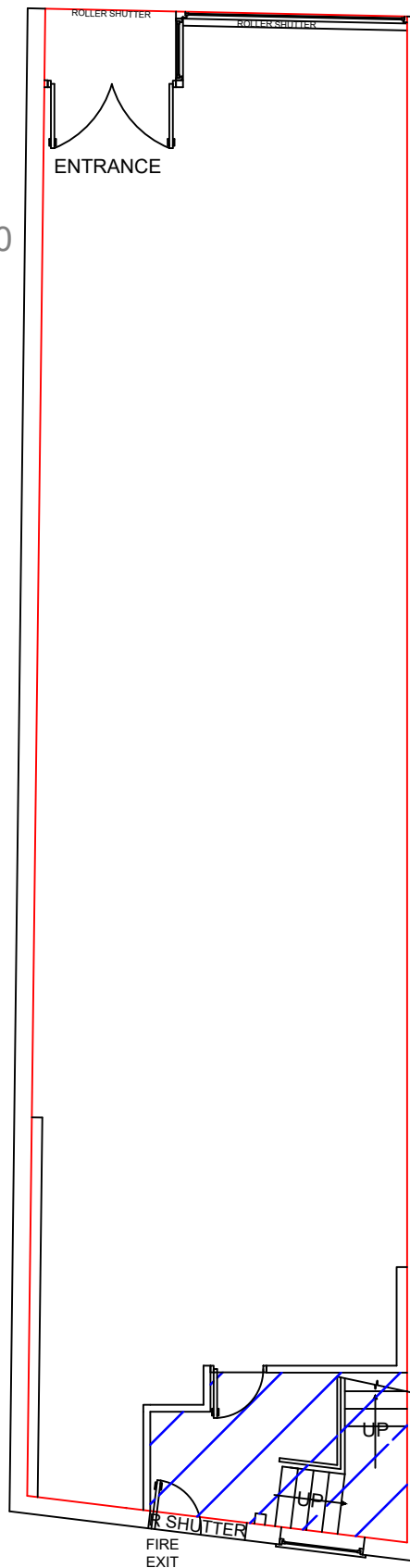

EXTRACT FROM ORDNANCE SURVEY @ 1:500, SHOWING LOCATION



AJK Drawing Services Ltd.
94 Potters Field
Harlow
Essex
CM17 9DA
tel: 07985-425446, 01279-498371
john.klement@ajk-surveying.com

Date: 23rd January 2025

Drafted by:
J. Klement LLB(Hons) Grad Dip

Project: Lease/ Title plan

Property details:
40 Long Wyre street
Colchester
CO1 1LJ

Scale 1:100@A3

Drawing No:LWS-40/01

©AJK Drawing services Ltd